

# DYNASET

POWERED BY HYDRAULICS

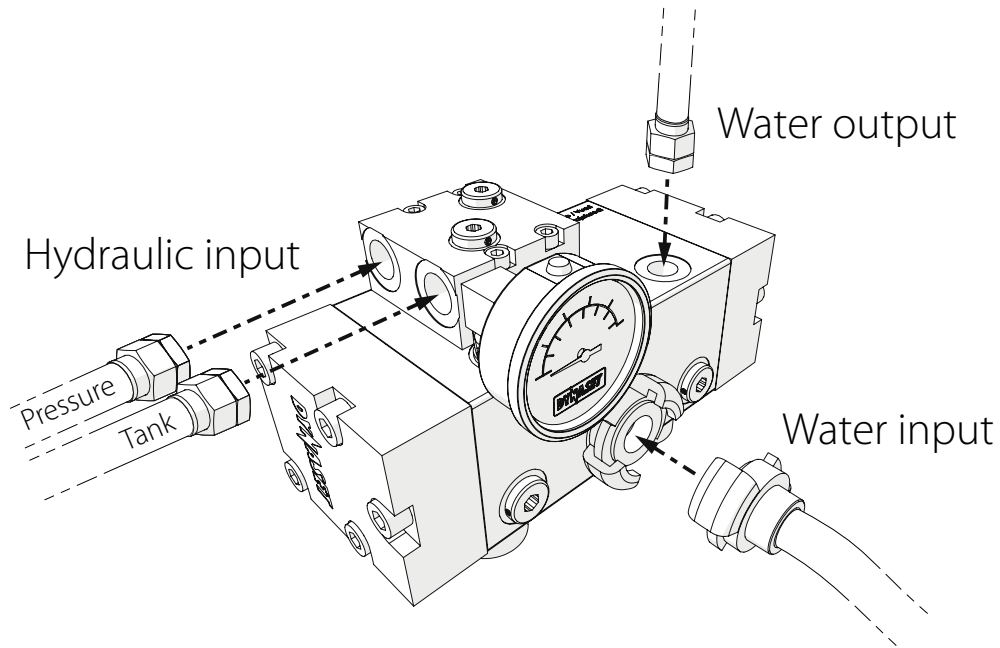

Location of input and output ports differ between High Pressure Water Pump models.

CONNECTION PORTS		HPW 90 /150-85	HPW 130 /180-140	HPW 180 /90-115	HPW 200 /30-45	HPW 220 /50-70	HPW 300 /300-350	HPW 320 /75-125	HPW 360 /220-360
Pressure line	P	BSP 3/4"	BSP 3/4"	BSP 3/4"	BSP 1/2"	BSP 3/4"	SAE 6000 1 1/4"	BSP 3/4"	SAE 6000 1 1/4"
Tank line	T	BSP 3/4"	BSP 3/4"	BSP 3/4"	BSP 1/2"	BSP 3/4"	SAE 6000 1 1/4"	BSP 3/4"	SAE 6000 1 1/4"
Water input	S	BSP 2"	BSP 2"	BSP 1 1/4"	BSP 3/4"	BSP 1"	SAE 3000 2"	BSP 1/2"	SAE 3000 2"
Water output	WP	BSP 1"	BSP 1"	BSP 3/4"	BSP 3/8"	BSP 1/2"	SAE 6000 1" (BSP 3/4")	BSP 1 1/4"	SAE 6000 1" (BSP 3/4")

CONNECTION PORTS		HPW 420 /20-50	HPW 460 /50-115	HPW 520 /30-85	HPW 800 /30-140	HPW 1000 /30-140	HPW 1200 /100-440	HPW 1600 /15-140
Pressure line	P	BSP 1/2"	BSP 3/4"	BSP 3/4"	BSP 3/4"	BSP 3/4"	SAE 6000 1 1/4"	BSP 3/4"
Tank line	T	BSP 1/2"	BSP 3/4"	BSP 3/4"	BSP 3/4"	BSP 3/4"	SAE 6000 1 1/4"	BSP 3/4"
Water input	S	BSP 3/4"	BSP 1"	BSP 3/4"	BSP 3/4"	BSP 3/4"	SAE 3000 2"	BSP 1/2"
Water output	WP	BSP 3/8"	BSP 1/2"	BSP 3/8"	BSP 3/8"	MP 9/16"	MP 3/4"	HP 1/4"

**REPARK**  
www.REPARK.lv

## QUICK GUIDE HIGH PRESSURE WATER PUMPS

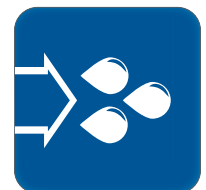

HPW 90      HPW 200      HPW 320      HPW 460      HPW 1000  
 HPW 130      HPW 220      HPW 360      HPW 520      HPW 1200  
 HPW 180      HPW 300      HPW 420      HPW 800      HPW 1600

Download the full User Manual from [www.dynaset.com/manuals](http://www.dynaset.com/manuals)

Keycode for download: DM4YRG

# Ensure

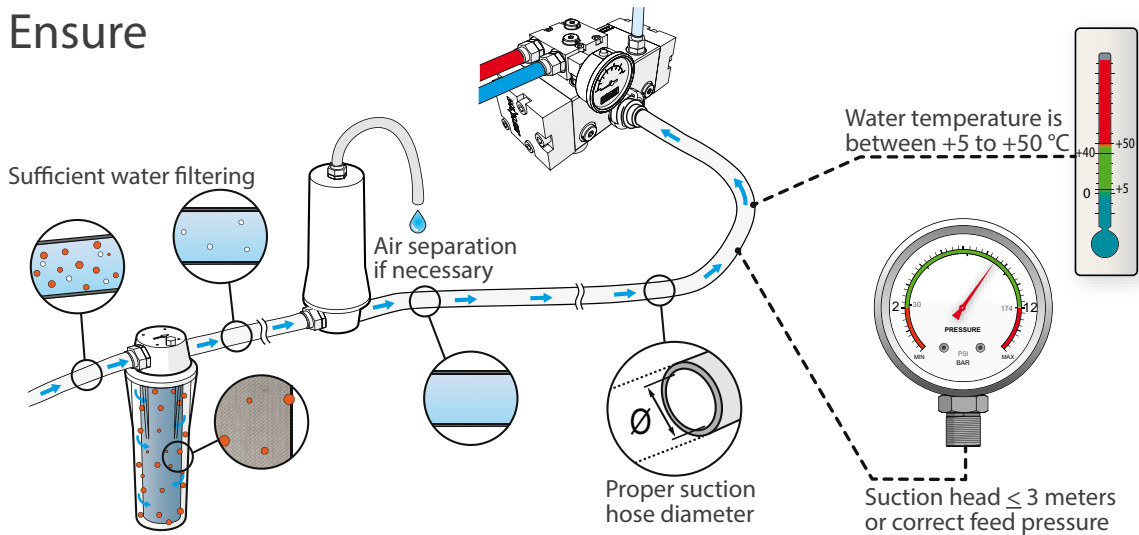

## HYDRAULIC FLUID REQUIREMENTS

Viscosity	cSt	10-200 / optimum 25-35
Temperature *	° C (° F)	max. 70 (158)
Filter ratio	µm	min. 25

\* Depending on hydraulic fluid. Read more on user manual chapter 6.2 "Hydraulic fluids".

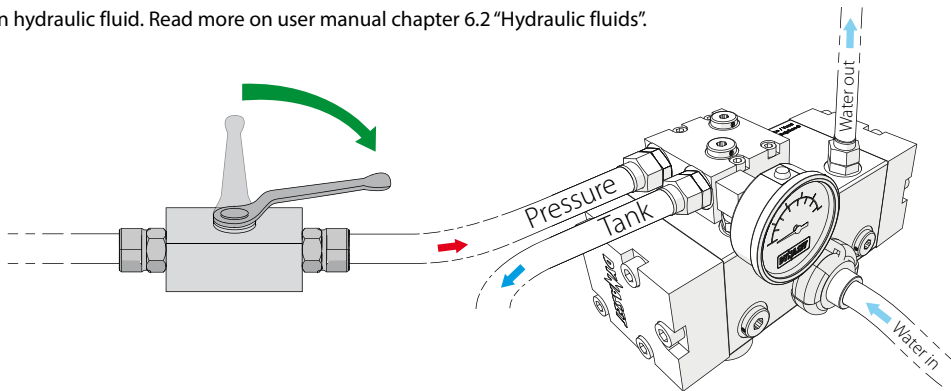

The HPW pump is started by opening the hydraulic control valve.

<b>HPW 200</b> /30-45	<b>HPW 420</b> /20-50	<b>HPW 220</b> /50-70	<b>HPW 90</b> /150-85	<b>HPW 520</b> /30-85	<b>HPW 180</b> /90-115	<b>HPW 460</b> /50-115
--------------------------	--------------------------	--------------------------	--------------------------	--------------------------	---------------------------	---------------------------

## HYDRAULIC POWER REQUIREMENTS

Oil flow max.	l/min (gpm)	40 (10.6)	50 (13.2)	70 (18.5)	85(22.5)	85 (22.5)	115 (30.4)	115 (30.4)
Pressure max.	bar (psi)	210 (3000)	220 (3200)	210 (3000)	210 (3000)	250 (3600)	210 (3000)	250 (3600)

<b>HPW 130</b> /180-140	<b>HPW 320</b> /75-125	<b>HPW 800</b> /30-140	<b>HPW 1600</b> /15-140	<b>HPW 1000</b> /30-140	<b>HPW 360</b> /220-360	<b>HPW 300</b> /300-350	<b>HPW 1200</b> /100-440
----------------------------	---------------------------	---------------------------	----------------------------	----------------------------	----------------------------	----------------------------	-----------------------------

## HYDRAULIC POWER REQUIREMENTS

Oil flow max.	l/min (gpm)	140 (37.0)	125 (33.0)	140 (37.0)	140 (37.0)	140 (37.0)	360 (95.0)	350 (92.5)	440 (116.0)
Pressure max.	bar (psi)	250 (3600)	250 (3600)	210 (3000)	230 (3300)	280 (4100)	250 (3600)	350 (5100)	350 (5100)

READ THE DETAILED SAFETY, OPERATING AND INSTALLATION INSTRUCTIONS FROM THE USER MANUAL!



Download the full user manual  
[www.dynaset.com/manuals](http://www.dynaset.com/manuals)

Menotie 3 FI-33470 Ylöjärvi, Finland  
 tel: +358 3 3488 200  
 info@DYNASET.com

**REPARK**  
[www.REPARK.IV](http://www.REPARK.IV)